

KEYSHAPE FENDERS

The Engineer Company's keyshape fenders are specially designed for Tug and Work boats, they are made of high abrasion resistance rubber with excellent resilience properties for the required application. These fenders are very tough but can be curved around the hull allowing fixing of this product to be very simple.

Key Features:

- Heavy duty design
- Curves around bends
- Easy installation

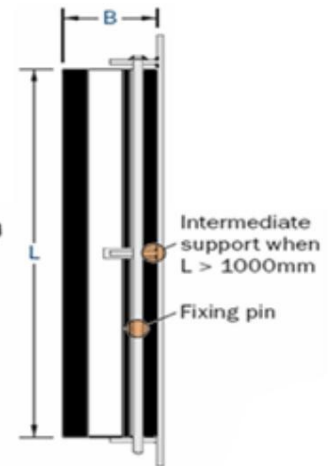
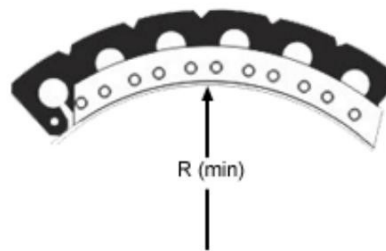
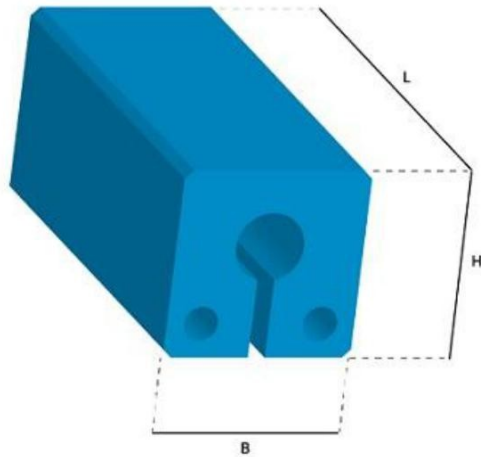

Product Reference	B x H mm	Pin Dia. mm	Flat Bar mm	R min	L Max. mm
ECR-KH200	200 x 200	25	100 x 15	450	2000
ECR-KH250	250 x 250	30	125 x 20	600	2000
ECR-KH300	300 x 300	30	150 x 20	800	2000
ECR-KH350	350 x 350	30	175 x 25	1000	2000
ECR-KH400	400 x 400		200 x 25	1200	2000

The information contained on this product information sheet is to be used as guidance. The advice is given in good faith and does not constitute any guarantee or recommendation for suitability. The Engineer Company cannot be held liable for any damage caused by incorrect installation. We hereby reserve the right to change the technical information herewith without notification or prior agreement.